

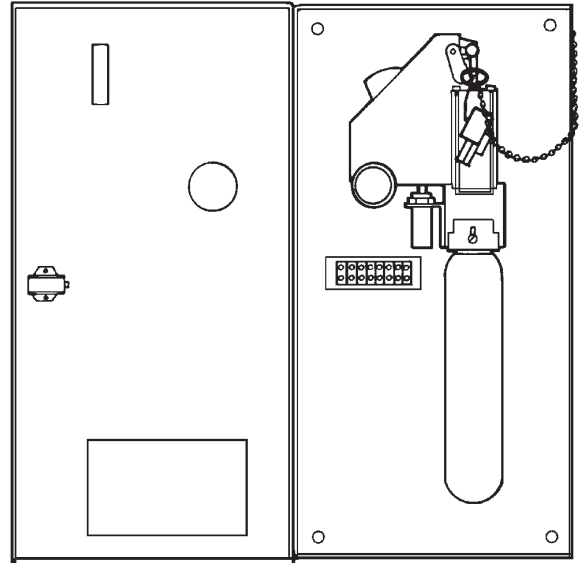

ANSUL AUTOMAN II-C Releasing Device (For Pneumatic Actuation)

The ANSUL AUTOMAN II-C Releasing Device consists of a metal enclosure which contains a spring-loaded puncture pin release mechanism, an actuation cartridge, electrical circuitry, and an input/output terminal strip for making electrical connections. The ANSUL AUTOMAN II-C releasing device provides automatic pneumatic actuation of the SAPPHIRE System. When wired to an AUTOPULSE Control system, it will provide supervised electric detection and release. It also provides manual actuation using the strike button on the release. When an AUTOPULSE Control System is used, manual actuation is accomplished using an electric manual pull station.

The ANSUL AUTOMAN II-C releasing device requires an
▶ LT-30-R nitrogen cartridge for system actuation. Cartridge must be ordered separately.



000442

| Component | Approvals |
|-------------------------------------|--|
| ANSUL AUTOMAN II-C Releasing Device | UL Listed ULC Listed FM Approved |

| Shipping Assembly Part No. | Description |
|----------------------------|---|
| ▶ 17728 | ANSUL AUTOMAN II-C Releasing Device |
| ▶ 5373 | LT-30-R Nitrogen Cartridge (order separately) |
| 26310 | Cocking Lever (order separately) |