

Component Description

Cylinder Mounting Cradle Data Sheet

FEATURES

- UL Listed, ULC Listed, and FM Approved for use with the systems listed in the Table , “COMPATIBILITY,” on page 2

P/Ns: 06-235431-001, WK-281867-000, WK-294652-000, and 06-118300-001

Cylinders of 125 lb. capacity and above are further supported with cylinder cradles. Cradles are used to mount the cylinders in a vertical position.

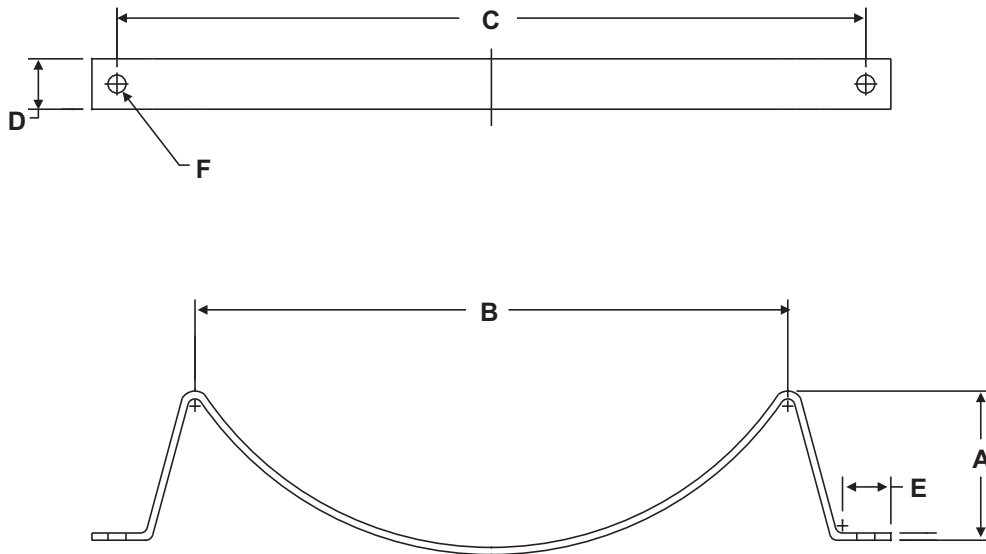

Part Number	Cylinder Size	Cylinder O.D.	Dimension					
			A	B	C	D	E	F
06-235431-001	125 lb., 200 lb.	12.75 in. (324 mm)	3.20 in. (81 mm)	16.25 in. (413 mm)	15 in. (381 mm)	1.50 in. (38 mm)	1.31 in. (33 mm)	0.56 in. (14 mm)
WK-281867-000	350 lb.	16 in. (406 mm)	3.58 in. (91 mm)	19.24 in. (489 mm)	18 in. (457 mm)	1.50 in. (38 mm)	1.34 in. (34 mm)	0.56 in. (14 mm)
WK-294652-000	600 lb.	22 in. (559 mm)	4.75 in. (121 mm)	25.24 in. (641 mm)	24 in. (610 mm)	1.75 in. (44 mm)	1.34 in. (34 mm)	0.56 in. (14 mm)
06-118300-001	900 lb.	24 in. (610 mm)	5.18 in. (132 mm)	27.74 in. (705 mm)	26 in. (660 mm)	1.75 in. (44 mm)	1.68 in. (43 mm)	0.63 in. (16 mm)

MATERIALS

- Steel, Zinc Painted Gray AISI M1020

COMPATIBILITY

Series	DIOM P/N
Kidde ECS 500 psi with FK-5-1-12 Agent	06-237585-001
Kidde ECS with 3M™ Novec™ 1230 Fire Protection Fluid	06-236553-001
Kidde ADS with 3M™ Novec™ 1230 Fire Protection Fluid	06-237256-001
Kidde Marine with 3M™ Novec™ 1230 Fire Protection Fluid	06-236559-001
Kidde ADS Marine with 3M™ Novec™ 1230 Fire Protection Fluid	06-237257-001
Kidde ECS with HFC-227ea Agent	06-236115-001
Kidde Modular ECS with HFC-227ea Agent	06-236116-001
Kidde ECS Marine with HFC-227ea Agent	06-236225-001
Kidde ADS Marine with HFC-227ea Agent	06-236595-001

EXPORT INFORMATION (USA)

Jurisdiction: EAR
Classification: EAR99

This document contains technical data subject to the EAR.

All trademarks are the property of their respective owners.

This literature is provided for informational purposes only. KIDDE-FENWAL, INC. believes this data to be accurate, but it is published and presented without any guarantee or warranty whatsoever. KIDDE-FENWAL, INC. assumes no responsibility for the product's suitability for a particular application. The fire suppression system design, installation, maintenance, service and troubleshooting must be performed by trained, authorized Kidde Fire Systems distributors for the product to work correctly. If you need more information on this product, or if you have a particular problem or question, contact: KIDDE-FENWAL, INC., Ashland, MA 01721 USA, Telephone: (508) 881-2000.

