

Product	Type	Mass	Body dimensions					
			L1	L2	L3	L4	L5	L6
B03720.1	X25S/2x12S	0,84 kg	M36x2	76	52	72	57	M20x1,5
B03740.1	X30S/2x12S	0,99 kg	M42x2	81	54	78	63	M20x1,5
B03750.1	X30S/2x20S	1,31 kg	M42x2	88	61	78	57	M30x2
B03760.1	X38S/2x12S	1,37 kg	M52x2	85	53	88	73	M20x1,5
B03770.1	X38S/2x25S	2,20 kg	M52x2	104	72	94	70	M36x2

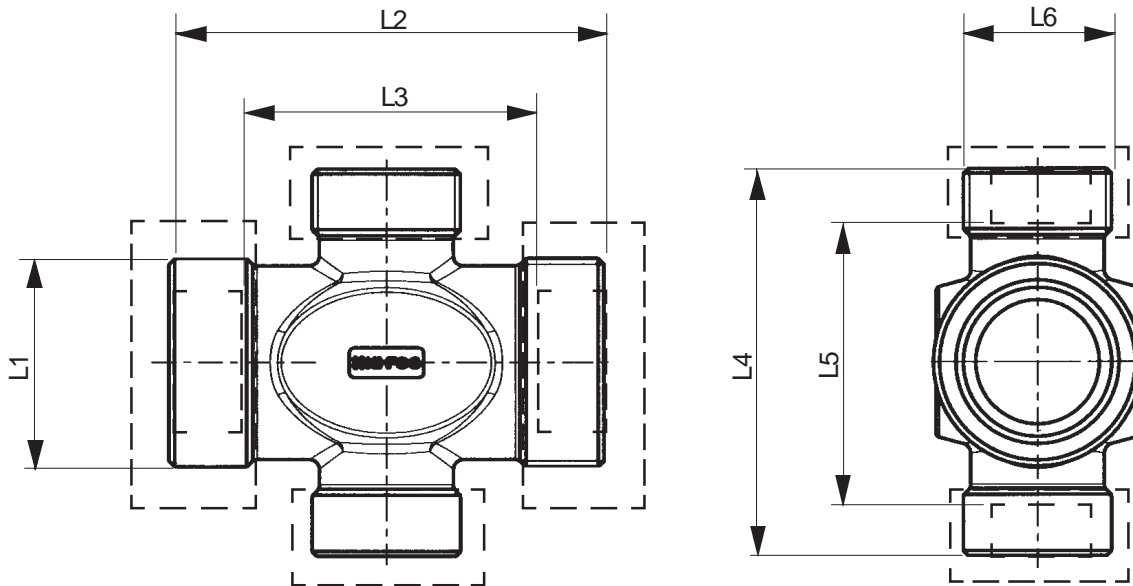

General	Body material cast stainless steel type 316. Cutting rings material stainless steel type 316. Nuts material zinc coated steel.
Connection	Thread for cutting ring connection DIN2353
Installation example (B03750.1)	