

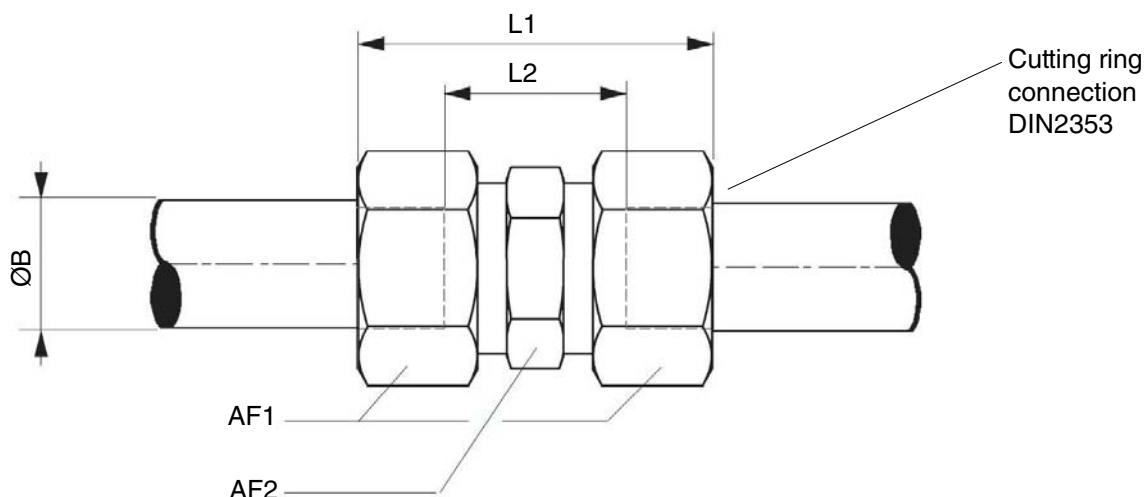

# Straight fittings

Stock codes: See tables below

TECHNICAL DATA SHEET TB3010 REVISION D DATE OF ISSUE 9 Mar 2016



Straight fitting assemblies of different sizes are listed in the tables below. Material alternatives can be seen from the type code as follows:

- A at the end of the type code stands for ASTM 316 body with zinc nuts, and
- B for ASTM 316 body with ASTM 316 nuts.

Stock code	Type code	Mass (kg)	Body material	ØB	L1	L2	AF1	AF2
A-0001641	G8-S-A	0,09	EN 1.4401 / ASTM 316	8	48	18	19	17

Stock code	Type code	Mass (kg)	Body material	ØB	L1	L2	AF1	AF2
A-0001596	G12-S-A	0,14	EN 1.4401 / ASTM 316	12	49	19	24	22
B01020.1	G12-S-B	0,14	EN 1.4401 / ASTM 316	12	49	19	24	22

Stock code	Type code	Mass (kg)	Body material	ØB	L1	L2	AF1	AF2
A-0001597	G16-S-A	0,23	EN 1.4401 / ASTM 316	16	58	21	30	27
B01025.1	G16-S-B	0,23	EN 1.4401 / ASTM 316	16	58	21	30	27

# Straight fittings

Stock code	Type code	Mass (kg)	Body material	ØB	L1	L2	AF1	AF2
A-0001599	G25-S-A	0,68	EN 1.4401 / ASTM 316	25	77	26	46	41
B01036	G25-S-B	0,68	EN 1.4401 / ASTM 316	25	77	26	46	41

Stock code	Type code	Mass (kg)	Body material	ØB	L1	L2	AF1	AF2
A-0001600	G30-S-A	0,76	EN 1.4401 / ASTM 316	30	88	27	50	41
B01040.1	G30-S-B	0,76	EN 1.4401 / ASTM 316	30	88	27	50	41

Stock code	Type code	Mass (kg)	Body material	ØB	L1	L2	AF1	AF2
A-0001601	G38-S-A	1,17	EN 1.4401 / ASTM 316	38	91	29	60	50
B01045.1	G38-S-B	1,17	EN 1.4401 / ASTM 316	38	91	29	60	50